

# TKZP

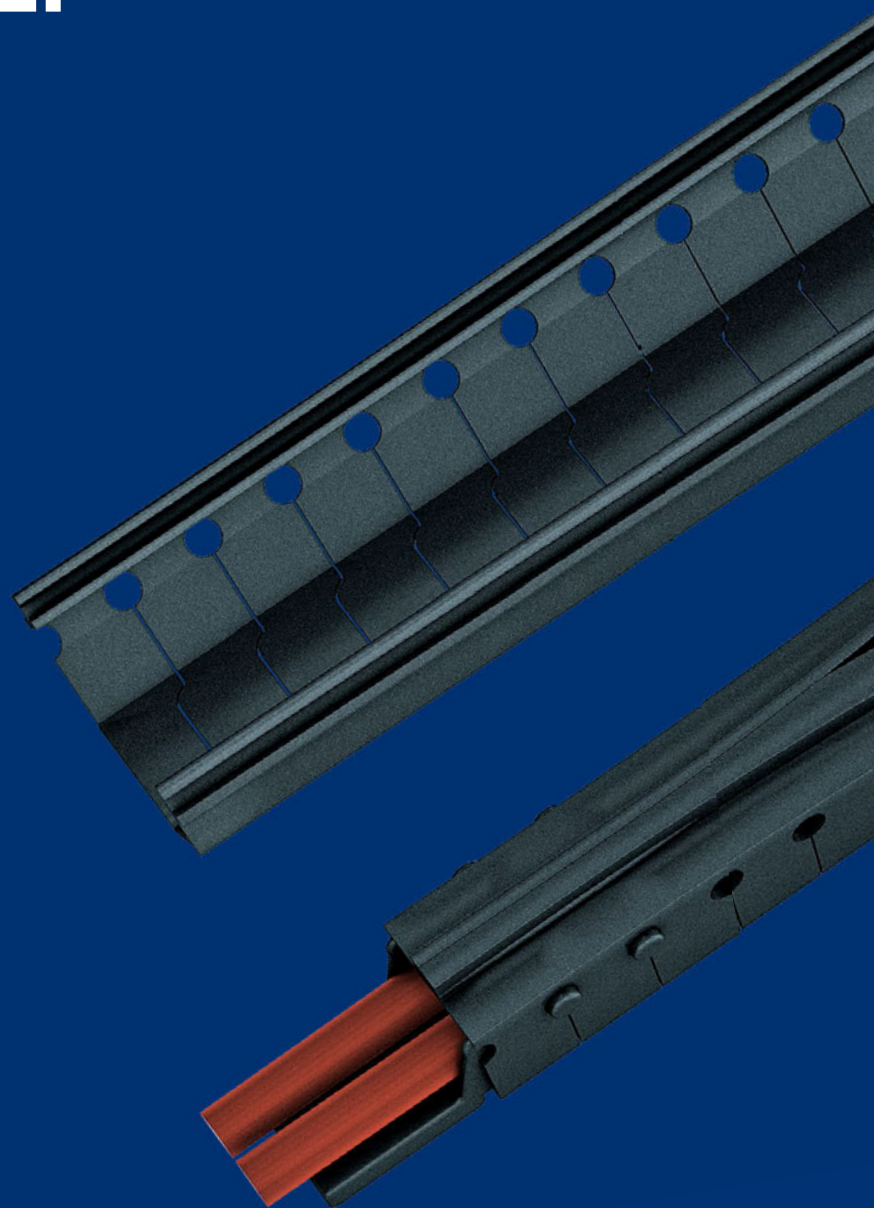



**Inside heights**  
13 mm



**Inside widths**  
10 – 15 mm



**Pitch**  
10 mm



**Additional load**  
up to 0.1 kg/m



**Travel length  
unsupported**  
up to 1 m



**Travel speed**  
up to 1.66 m/s



**Travel acceleration**  
up to 5 m/s<sup>2</sup>

All technical data and features are application and type-dependent.

Let us know your requirements – we are here to help!

Inside  
heightsInside  
widths
[kabelschlepp.de](http://kabelschlepp.de)

Fon:  
+49 2762 4003-0

Use our free  
project planning service.

## BASIC LINE PLUS | TKZP

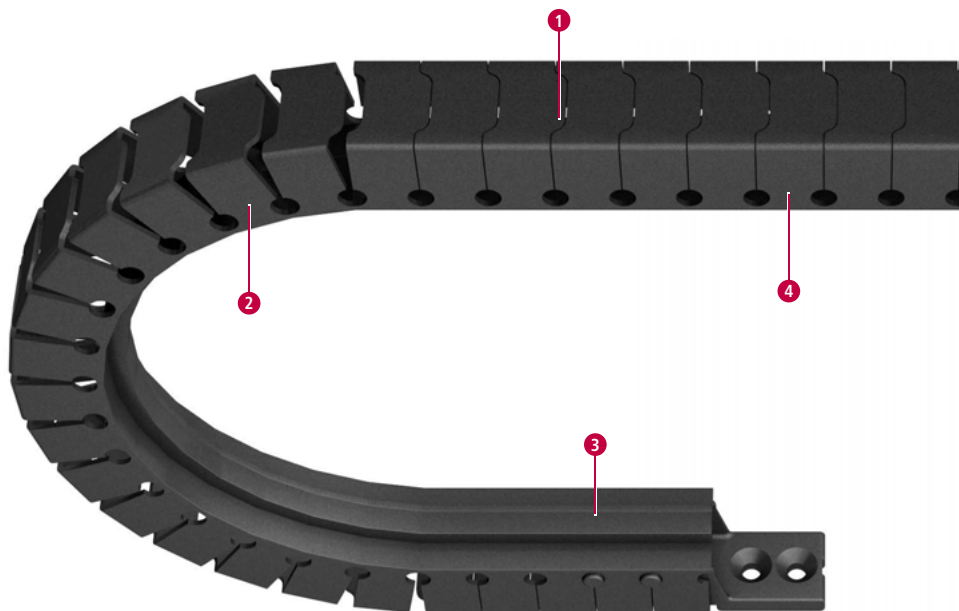

### Features

- Easy cable routing due to folding structure
- Routing of the cable also possible with cables assembled
- Easy adaptation to the chain length
- Low weight, good ratio between interior and exterior width
- Compact external dimensions for very restricted installation areas
- Quiet operation due to short partition and extruded profile
- Vibration-free process, also at high speeds and accelerations
- Low dust generation, because there is no friction between the chain links
- Flexible, also for side movement



Practically no polygon  
effect



Quick opening and  
closing due to the design  
similar to a zip



Low-wear, design made  
from extruded profiles  
with no joints

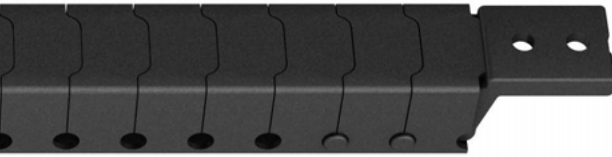

Example of cross section

- 1 Vibration-free process due to extremely reduced polygon effect
- 2 Design with no joints
- 3 Quick opening and closing due to the design similar to a zip
- 4 Suitable for very restricted installation areas

Inside heights



Inside widths



kabelschlepp.de

Fon: +49 2762 4003-0

OnlineEngineer.de  
TSUBAKI KABELSCHLEPP  
 Cable Carrier Configurator

## Selection criteria for TKZP

- If very quick opening of the zip-style opener is required
- If the installation area is very restricted
- If a smaller bend radius is required for a greater internal height
- If very smooth operation of the cable carrier is required
- If no cover on the cable carrier is required
- If no individual links should be hinged
- If no internal partitioning is required
- If no sliding arrangement is required

Type	$h_i$ [mm]	$B_i$ [mm]	$t$ [mm]	Page
TKZP10	13	10, 15	10	146

Inside  
heightsInside  
widths
[kabelschlepp.de](http://kabelschlepp.de)

 Fon:  
 +49 2762 4003-0

 Use our free  
 project planning service.

146

# TKZP

**Pitch**  
 10 mm

**Height**  
 13 mm

**Width**  
 10 – 15 mm

 Spare parts list, installation instructions, etc.:  
 Receive additional info at [kabelschlepp.de](http://kabelschlepp.de)

## BASIC LINE PLUS | TKZP10

### Unsupported arrangement

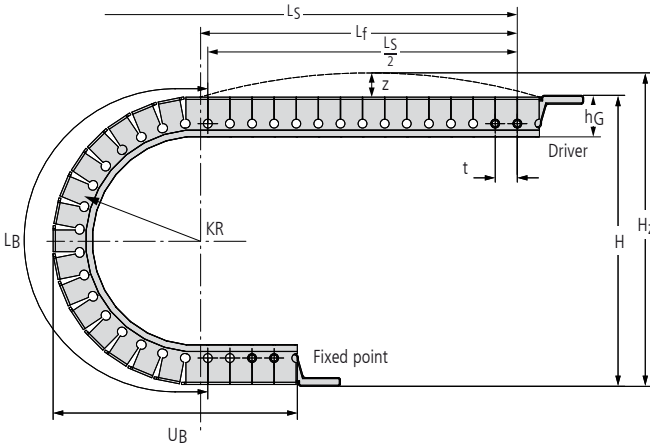

#### Unsupported length Lf

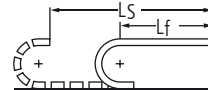

A sag of the cable carrier is technically permissible for extended movement ranges, depending on specific application.

#### Inside heights



#### Inside widths



kabelschlepp.de

LS max. [m]	Dynamics		t [mm]
	vmax [m/s]	amax [m/s]	
1	1.66	5	10

### Installation measurements unsupported

H [mm]	H <sub>z</sub> [mm]	L <sub>B</sub> [mm]	U <sub>B</sub> [mm]
150	Depending on cable	218	111

**Note:** For order example and notes for ordering, refer to Page 150

Fon: +49 2762 4003-0

OnlineEngineer.de  
TSUBAKI KABELSCHLEPP  
 Cable Carrier Configuration

## BASIC LINE PLUS | TKZP10

## Stay variant

can be opened internally due to the design similar to a zip

Inside  
heightsInside  
widths

kabelschlepp.de

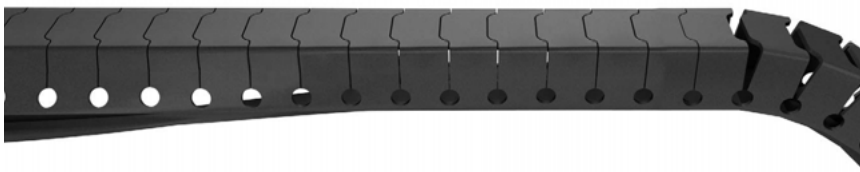

## Pitch, inside height and chain link height

Type	t [mm]	h <sub>i</sub> [mm]	h <sub>G</sub> [mm]
TKZP10	10	13	15

Fon:

+49 2762 4003-0

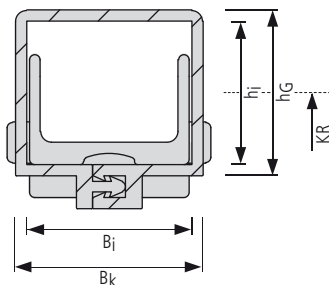

## Inside/outside width and intrinsic chain weight

Type	B <sub>i</sub> [mm]	B <sub>k</sub> [mm]	q <sub>k</sub> [kg/m]
TKZP10	10	12	0.06
TKZP10	15	17	0.07

Use our free  
project planning service.

## BASIC LINE PLUS | TKZP10

### Connecting elements made from plastic

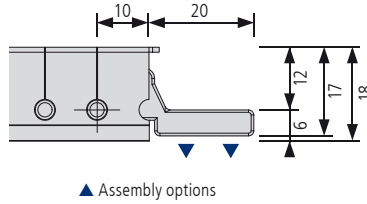
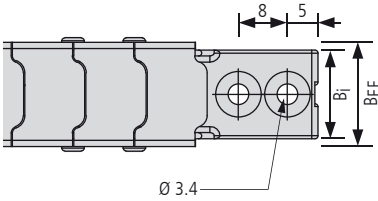

▲ Assembly options

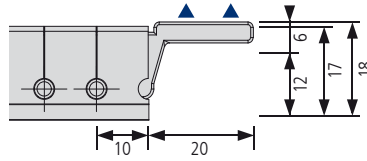

▲ Montagemöglichkeiten

Inside heights



Inside widths



### Connection dimensions

$B_i$ [mm]	$BEF$ [mm]
10	12
15	17

### Connection variants

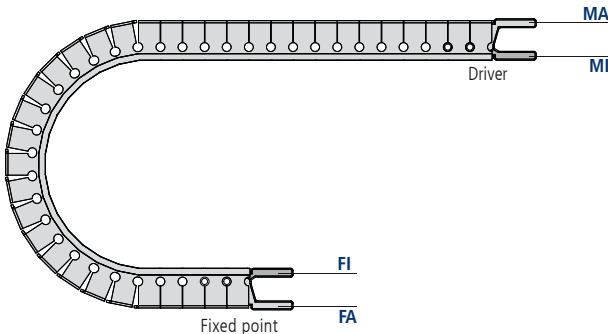

Fon: +49 2762 4003-0

OnlineEngineer.de  
Das Kabelschlepp-Engineering  
 Cable Carrier Configuration



Inside  
heightsInside  
widths

kabelschlepp.de

Fon:  
+49 2762 4003-0Use our free  
project planning service.

## BASIC LINE PLUS | TKZP

## Ordering

## Ordering example cable carrier

## Cable carrier

TKZP10	.	10	-	230
Type		Bj [mm]		LK [mm]

## Ordering example connection elements

## Connection

FA	/	MA
Fixed point		Driver

-  **Note:** The cable carrier is available by the metre. 1 VE = 10 m.  
Connecting elements are available in the VE = 10 off.



## See online for additional product information

Spare parts list, installation instructions, etc.:  
Receive additional info at [kabelschlepp.de](http://kabelschlepp.de)

Configure your custom  
cable carrier system:  
[onlineengineer.de](http://onlineengineer.de)



## Guide channels

- from page 375

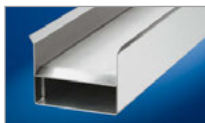

## Strain relief devices

- from page 381



## Cables for cable carrier systems

- from page 438



