

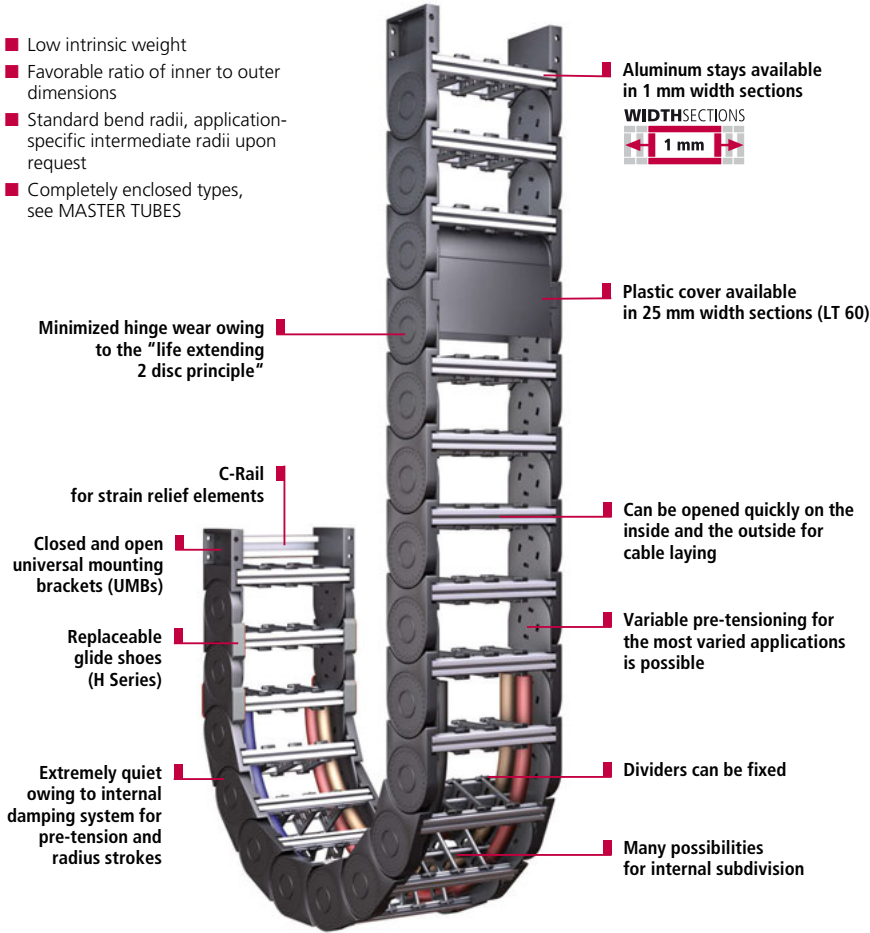

MASTER Series

Quiet and weight-optimized cable carriers*

- Low intrinsic weight
- Favorable ratio of inner to outer dimensions
- Standard bend radii, application-specific intermediate radii upon request
- Completely enclosed types, see MASTER TUBES



Minimized hinge wear owing to the "life extending 2 disc principle"

Aluminum stays available in 1 mm width sections



Inside heights



Inside widths



Plastic cover available in 25 mm width sections (LT 60)

C-Rail for strain relief elements

Closed and open universal mounting brackets (UMBs)

Replaceable glide shoes (H Series)

Extremely quiet owing to internal damping system for pre-tension and radius strokes

Can be opened quickly on the inside and the outside for cable laying

Variable pre-tensioning for the most varied applications is possible

Dividers can be fixed

Many possibilities for internal subdivision

kabelschlepp.de

Font: +49 2762 4003-0

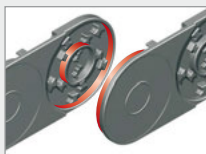

Minimized hinge wear owing to the "life extending 2 disc principle"



C-Rails integrated in the connector

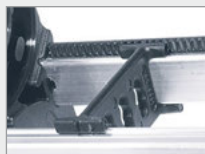

Dividers can be fixed for installations where the carrier is rotated through 90° and applications with high transverse accelerations



Many separation options for the cables

* Some features can be different for certain types for design reasons. Our specialists are happy to advise you.

Types MASTER HC/LC

with aluminum stays

- Available in 1 mm width sections (standard widths in 25 mm steps available ex-stock)

Inside heights



Inside widths



WIDTHSECTIONS



kabelschlepp.de

Type	h _i	B _i	Maximum travel length in m	Dynamics of unsupported arrangement		Page
				Travel speed v _{max} in m/s	Travel acceleration a _{max} in m/s ²	
HC 33	33	50 – 400	60	10	50	173
HC 46	46	50 – 400	80	8	40	173
LC 60	60	75 – 600	7*	6	30	173
LC 80	80	100 – 800	8*	5	25	173

* only unsupported

Dimensions in mm

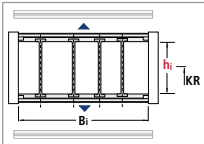

Stay variants

Frame stay RSH

Frame stay made of aluminum

Opening options:

Outside/inside: the cable carrier can be opened quickly and easily simply by rotating the stays.

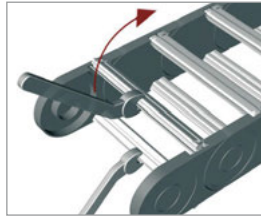

Stay arrangement

Stays mounted on every chain link.

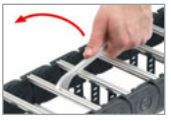

Put the tool in place, turn it through 15° and the chain is open.

Fon: +49 2762 4003-0

Use our free project planning service.

TUBE SERIES – covered cable carriers

Types LT with plastic cover system



Types MASTER HC 33/46, LC 60/80

Dimensions and intrinsic chain weight

Type	Stay variant	h _i	h _G	B _i min*	q _k min	B _i max*	q _k max	B _k
HC 33	RSH	33	51	50	1.37	400	3.99	B _i + 22
HC 46	RSH	46	64	50	1.83	400	4.01	B _i + 26
LC 60	RSH	60	88	75	2.78	600	7.10	B _i + 28
LC 80	RSH	80	110	100	3.89	800	10.01	B _i + 32

* Standard widths in 25 mm steps

Dimensions in mm/Weights in kg/m

WIDTH SECTIONS

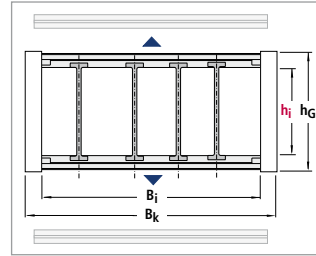

Inside heights



Inside widths



Bend radius and pitch

Type	Bend radii KR mm										
HC 33	60	75	100	125	150	175	200	220	250	300	-
HC 46	75	100	115	125	150	170	200	215	250	300	350
LC 60	135	150	200	250	300	350	400	500	-	-	-
LC 80	-	150	200	250	300	350	400	500	-	-	-

Pitch:

HC 33: t = 56 mm

HC 46: t = 67 mm

LC 60: t = 91 mm

LC 80: t = 111 mm

The listed values are standard bend radii.

For special applications it is also possible, to set any desired intermediate radii at the production stage.

Please do get in touch with us, we would be happy to advise you.

Load diagram

for unsupported length L_f depending on the additional load

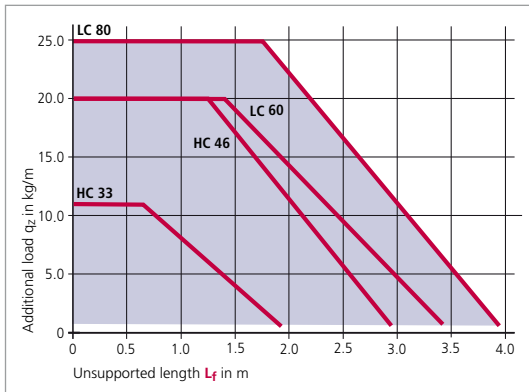

Unsupported length L_f

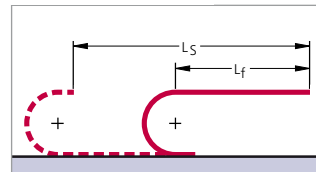

In the case of longer travel lengths, sag of the cable carriers is technically permissible depending on the application.

In a gliding arrangement, even longer travel lengths are possible (see page 375).

We are at your service to advise on these applications.

Font:

+49 2762 4003-0

Example of ordering

Cable carrier

HC 46	200	RSH	170	2010
Type	Inside width B _i in mm	Stay variant	Bend radius KR in mm	Chain length L _k in mm (without connection)

Divider system

TS 0	4
Divider system	Number of dividers n _T

Connection

FU/MU
Connection Fixed point/Driver

Ordering divider systems:

Please state the designation of the divider system (TS 0, TS 1 ...) and the number of dividers. Possibly attach a sketch with the dimensions.

Types MASTER HC 33/46, LC 60/80

Divider system TS 0

Inside heights



Inside widths



Type	h _i mm	S _T mm	a _T min mm	a _x min mm
HC 33	33	3	7	13
HC 46	46	3	7	13
LC 60	60	4	9	16
LC 80	80	4	9	16

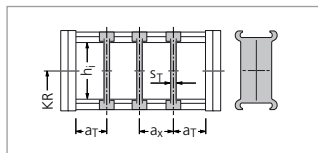

The dividers can be moved in the cross section. Dimensions in mm
In the standard version, the divider systems are mounted on every second chain link.



Divider system TS 1 with continuous height subdivision made of aluminum

Type	h _i mm	S _T mm	a _T min mm	a _x min mm	S _H mm	h ₁ mm	h ₂ mm	h ₃ mm	h ₄ mm
HC 33	33	3	7	13	4	18	–	–	–
HC 46	46	3	7	13	4	20	–	–	–
LC 60	60	4	9	16	4	15	30	45	–
LC 80	80	4	9	16	4	15	30	45	60

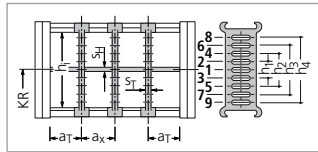

The dividers can be moved in the cross section. Dimensions in mm
In the standard version, the divider systems are mounted on every second chain link.



Divider system TS 3 with section subdivision, partitions made of plastic

Type	h _i mm	S _T mm	a _T min mm	a _x min mm	S _H mm	h ₁ mm	h ₂ mm	h ₃ mm	h ₄ mm
HC 33	33	8	6	16*	4	14	–	–	–
HC 46	46	8	6	16*	4	14	28	–	–
LC 60	60	8	6	16*	4	14	28	–	–
LC 80	80	8	6	16*	4	14	28	42	56

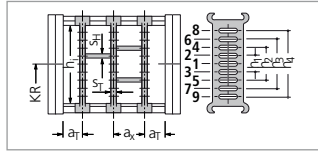

* When using plastic partitions Dimensions in mm
The dividers are fixed by the partitions, the complete divider system is movable.
In the standard version, the divider systems are mounted on every second chain link.



Dimensions of the plastic partitions for TS 3

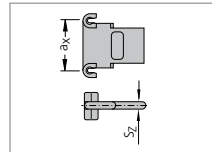

S _z	a _x (center-to-center dividers)									
	16	18	23	28	32	33	38	43	48	58
4	64	68	78	80	88	96	112	128	144	160
	176	192	208	–	–	–	–	–	–	–

Dimensions in mm

Aluminum partitions in 1 mm width sections are also available.
When using partitions with a_x > 112 mm there should be an additional central support with a twin divider.
Twin dividers are designed for subsequent fitting in the partition system.

Use our free project planning service.

Fon: +49 2762 4003-0

kabelschlepp.de

Types MASTER HC 33/46, LC 60/80

Fixing the dividers

In the standard version, dividers or the complete divider system (dividers with height subdivisions) can be moved in the cross section.

Fixing profiles can be used to fix the dividers or complete divider systems. Fixing in HC 33/46 and LC 60 in 2 mm steps, LC 80 in 3 mm steps.



■ Fixing on both sides ensures that the dividers have a secure hold.



■ Fixing of dividers with fixing profiles

If the fixed mounting version is desired, please state this when placing your order.

Inside heights



Inside widths



Glide shoes – the economical solution for gliding applications (HC 33/46)

Replaceable glide shoes made of plastic

To extend the life of cable carriers in gliding operations KABELSCHLEPP supplies detachable, exchangeable glide shoes. Replaceable glide shoes are a very economical solution. When wear occurs only the glide shoes are replaced, and not the complete cable carrier.

Glide shoes for the H Series are made of a highly wear-resistant special material.



Chain height with glide shoes:

HC 33: $h_G' = h_G + 3.2 = 54.2$
 HC 46: $h_G' = h_G + 3.2 = 67.2$

Dimensions in mm

Minimum bend radii when using glide shoes:

HC 33: $KR_{min} = 100$ mm
 HC 46: $KR_{min} = 100$ mm

! By means of a positive snap connection, the glide shoes sit firmly on the chain link.

Font: +49 2762 4003-0

kabelschlepp.de

Minimized hinge wear owing to the "life extending 2 disc principle"

In the MASTER Series, the push and pull forces are transmitted via the optimum link design for this purpose.

As a result link wear is reduced to a minimum and the life of the cable carrier is considerably lengthened.

The internal stopper and pre-tensioning dampers have a noise-muffling effect. This makes the chain particularly quiet.

Should your application require it, the pre-tensioning (in deviation from the standard pre-tensioning) can be adjusted at the time of production. We can produce a cable carrier with a pre-tension which is exactly suited to the load values of your application.

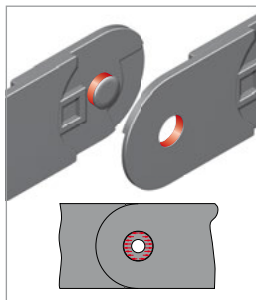

■ Force transmission with a pin-hole joint

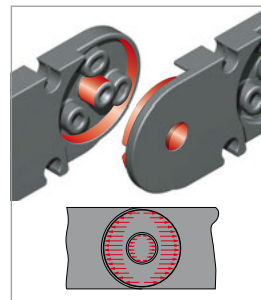

■ Force transmission with the "life extending 2 disc principle"

Types MASTER HC 33/46, LC 60/80

UMB (Universal Mounting Brackets) made of plastic

Various universal mounting brackets made of plastic provide a suitable connection for any assembly situation. Each type can be screwed from above, below or as a flange.

Inside heights



Inside widths



■ Standard connector

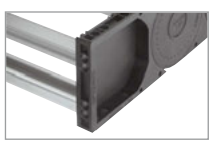

■ Long, closed connector for many of the hole patterns commercially available with large hole intervals (only LC)



■ Short, open connector, easy assembly owing to optimal accessibility of the holes in restricted installation conditions (only LC)

kabelschlepp.de

Connection dimensions Type HC 33

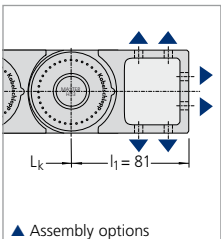

▲ Assembly options

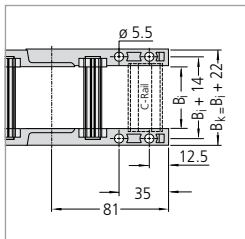
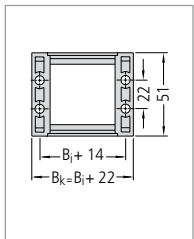

The dimensions of the fixed point and driver connections are identical!

Optional C-rails and strain relief elements for cables can be found on the following pages.

When ordering please specify the connection type FU/MU (see ordering key on page 419).

Fon: +49 2762 4003-0

Connection dimensions Type HC 46

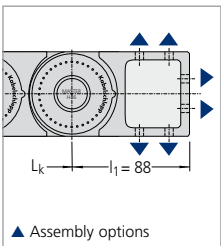

▲ Assembly options

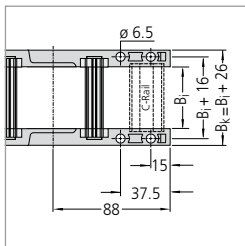
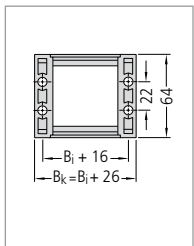

The dimensions of the fixed point and driver connections are identical!

Optional C-rails and strain relief elements for cables can be found on the following pages.

When ordering please specify the connection type FU/MU (see ordering key on page 419).

Use our free project planning service.

Inside heights



Inside widths



kabelschlepp.de

Fon: +49 2762 4003-0

OnlineEngineer.de
Hersteller KABELSCHLEPP
 CAD Center Engineering

Types MASTER HC 33/46, LC 60/80

Connection dimensions Type LC 60

Standard connector and short, open connector

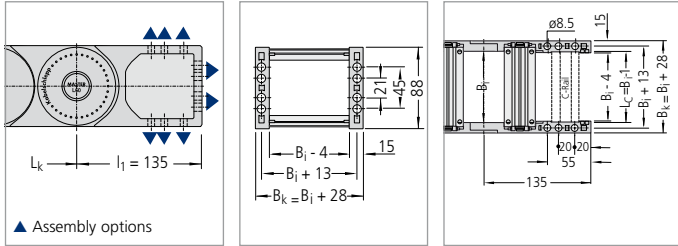

The dimensions of the fixed point and driver connections are identical!

Optional C-rails and strain relief elements for cables can be found on the following pages.

When ordering please specify the connection type FU/MU (see ordering key on page 419).

Connection dimensions Type LC 80

Standard connector and short, open connector

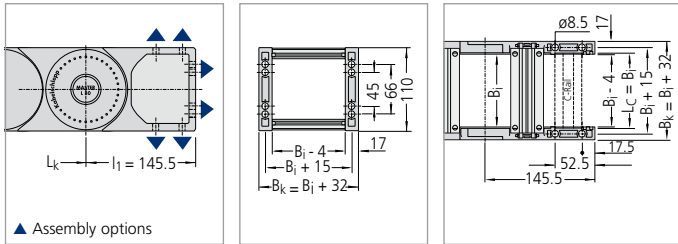

The dimensions of the fixed point and driver connections are identical!

Optional C-rails and strain relief elements for cables can be found on the following pages.

When ordering please specify the connection type FU/MU (see ordering key on page 419).

Long, closed connector

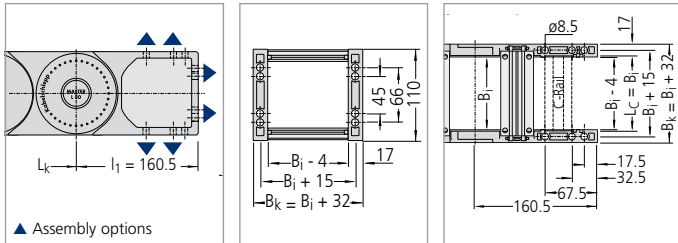

The dimensions of the fixed point and driver connections are identical!

Optional C-rails and strain relief elements for cables can be found on the following pages.

When ordering please specify the connection type FU/MU (see ordering key on page 419).

Types MASTER HC 33/46, LC 60/80

Strain relief devices

Strain relief combs made of plastic on both sides for standard carrier widths (MASTER HC)

The cables can be fixed securely and simply using the **optional strain relief combs**.

The strain relief combs are installed between the UMBs, and do not need to be bolted on separately or mounted on a C-Rail.

Please state on the order whether strain relief combs are needed.

Inside heights



Inside widths

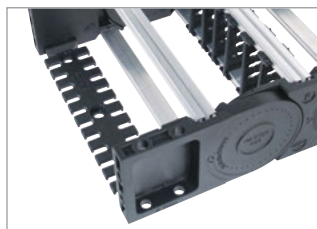

- Universal mounting bracket with strain relief comb



- Dual-sided strain relief comb

kabelschlepp.de



- Fixing in the UMB.

Type	B _i mm	n _z
HC 33/46	50	3
HC 33/46	75	5
HC 33/46	100	7
HC 33/46	125	9
HC 33/46	150	11
HC 33/46	175	13

n_z = Number of teeth on one side of the comb

* on request

Fon: +49 2762 4003-0

Strain relief comb made of aluminum on one side for individual carrier widths (MASTER HC)

The cables can be fixed securely and simply using the **optional strain relief combs**.

The strain relief combs are installed between the universal mounting brackets, and do not need to be bolted on separately or mounted on a C-Rail.

Please state on the order whether strain relief combs are needed.

Use our free project planning service.

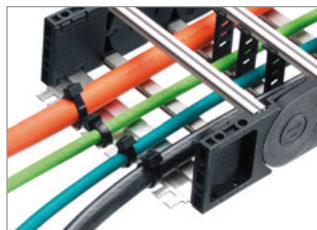

- Strain relief comb made of aluminum

Types MASTER HC 33/46, LC 60/80

Strain relief devices

C-rails for LineFix bracket clamps, SZL strain reliefs and clamps

The optional C-rails are fixed by means of the universal mounting brackets and do not have to be screwed separately.

Please state in your order whether C-rails are needed.



■ Universal mounting bracket with C-rail

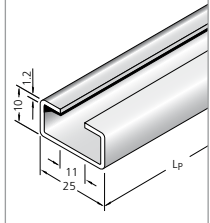

■ **MASTER HC:**
Integratable C-rail
25 x 10 mm,
slit width 11 mm,
material steel,
Item-No. 3931

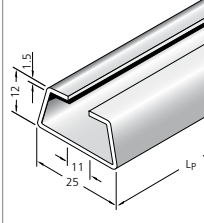

■ **MASTER LC:**
Integratable C-rail
25 x 12 mm,
slit width 11 mm,
material steel,
Item-No. 3934

Inside heights



Inside widths



Our LineFix strain reliefs are optimally suited for the C-rails. (LineFix bracket clamps and other strain relief devices – see Accessories chapter, from page 381 onwards).



■ C-rail with LineFix strain relief

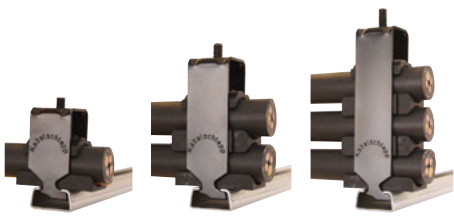

kabelschlepp.de

Font: +49 2762 4003-0

OnlineEngineer.de
Ihre Online-Engineer-Service-Plattform für Kabel Carrier-Systeme

Guide channels
➤ from page 375

Strain relief devices
➤ from page 381

Cables for cable carrier systems
➤ from page 438

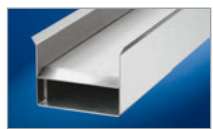

Subject to change.