

UNIFLEX

TUBES with fixed chain widths

Inside heights

19,5
-
44

Inside widths

15
-
175

- Solid plastic
- Easy to open
- Robust, double stroke system for long unsupported lengths
- Particularly high torsional rigidity
- End connectors with integrated strain relief
- Economically priced standard types
- TÜV design approved in accordance with 2PFG 1036/10.97

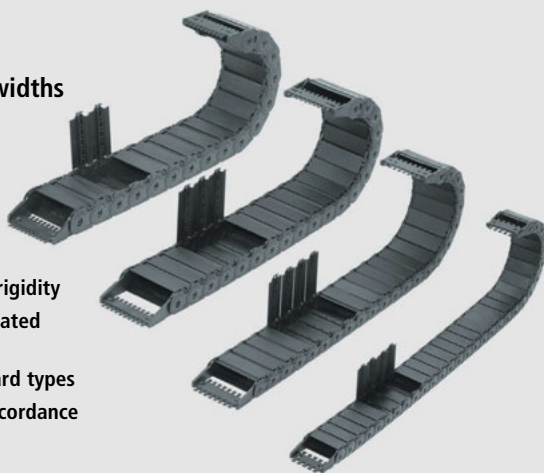

kabelschlepp.de

Design 050 – covered on one side

- Outside: Covered
- Inside: Hinged, openable (on the right/left) and detachable brackets



Fon: +49 2762 4003-0

Use our free project planning service.

Type	h_i	B_i	Maximum travel length in m	Dynamics of unsupported arrangement		Page
				Travel speed v_{max} in m/s	Travel acceleration a_{max} in m/s ²	
0345.050	20	15-65	80	10	50	104
0455.050	26	25-130	120	10	50	104
0555.050	38	50-150	125	9	45	104
0665.050	44	50-175	150	8	40	104

Dimensions in mm

Design 060 – covered on both sides

- Outside and inside: Covered
- Inside: Hinged, openable (on the right/left) and detachable cover

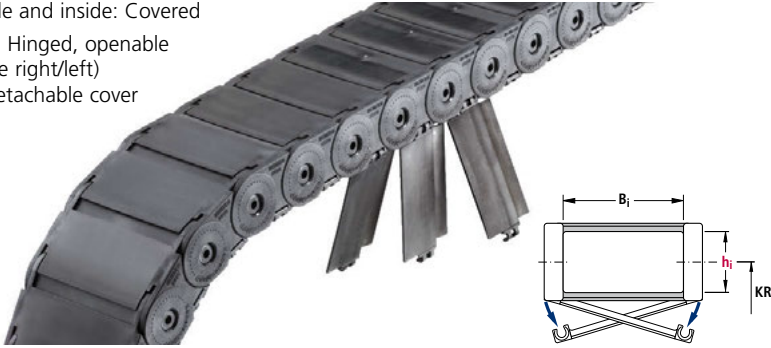

Inside heights



Inside widths



Type	h _i	B _i	Maximum travel length in m	Dynamics of unsupported arrangement		Page
				Travel speed v _{max} in m/s	Travel acceleration a _{max} in m/s ²	
0345.060	19.5	15-65	80	10	50	286
0455.060	25	25-130	120	10	50	286
0555.060	36	50-150	125	9	45	286
0665.060	42	50-175	150	8	40	286

Dimensions in mm

kabelschlepp.de

Design 080 – covered on both sides

- Outside and inside: Covered
- Outside: Detachable cover

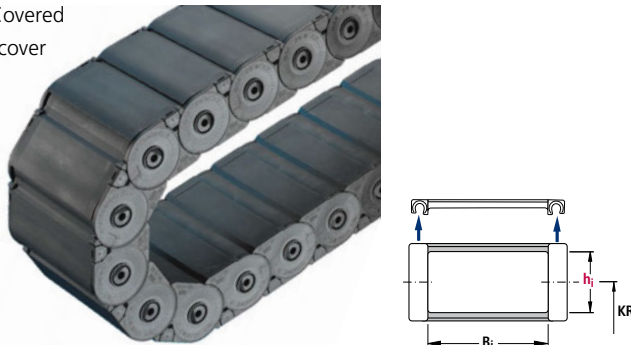

Type	h _i	B _i	Maximum travel length in m	Dynamics of unsupported arrangement		Page
				Travel speed v _{max} in m/s	Travel acceleration a _{max} in m/s ²	
0600.080	44	50-125	100	6	35	292

Dimensions in mm

Font: +49 2762 4003-0

OnlineEngineer.de
Hersteller von KABELSCHLEPP
 Cable Chain Engineering

UNIFLEX – Types 0345, 0455, 0555 and 0665

Design 060 – cable carriers covered on both sides

Outside and inside: Covered

Inside: Hinged, openable (on the right/left) and detachable covers

Inside heights



Inside widths

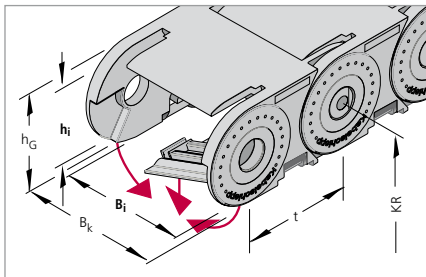

kabelschlepp.de

Dimensions and intrinsic chain weight

Type	h_i	h_G	Inside widths B_i						B_k
			Intrinsic chain weight						
0345	19.5	28	15	20	25	38	50	65	$B_i + 13$
			0.48	0.52	0.56	0.65	0.74	0.85	
0455	25	36	25	38	58	78	103	130	$B_i + 18$
			0.92	1.01	1.16	1.31	1.51	1.72	
0555	36	50	50	75	100	125	150	–	$B_i + 22$
			1.72	1.95	2.17	2.39	2.61	–	
0665	42	60	50	75	100	125	150	175	$B_i + 27$
			2.36	2.69	3.00	3.32	3.64	3.95	

Dimensions in mm/Weights in kg/m

Fon: +49 2762 4003-0

Bend radius and pitch

Type	Bend radii KR mm					
0345	75	100	125	150	–	–
0455	95	125	150	180	200	225
0555	100	125	160	200	230	–
0665	120	140	200	250	300	–

Pitch t:

Type 0345: 34.5 mm

Type 0455: 45.5 mm

Type 0555: 55.5 mm

Type 0665: 66.5 mm

Use our free project planning service.

Example of ordering

Cable carrier

· · · ·

Type Design Inside width B_i in mm Bend radius KR in mm Chain length L_k in mm (with-out connection)

Divider system

/

Divider system Number of dividers n_T

Connection

Connection Fixed point/Driver

Ordering divider systems:

Please state the designation of the divider system (TS 0, TS 1 ...) and the number of dividers. Possibly attach a sketch with the dimensions.

UNIFLEX – Types 0345, 0455, 0555 and 0665

Load diagram

for unsupported length L_f depending on the additional load

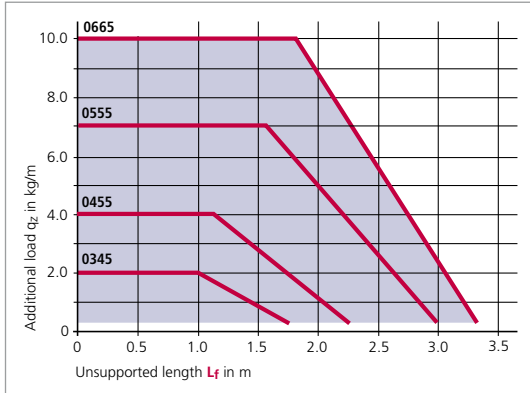

Unsupported length L_f

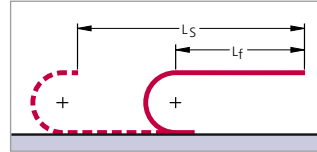

In the case of longer travel lengths, sag of the cable carriers is technically permissible depending on the application.

In a gliding arrangement, even longer travel lengths are possible (see page 375).

We are at your service to advise on these applications.

Inside heights

19,5
—
42

Inside widths

15
—
175

kabelschlepp.de

Divider system TS 0

Type	h_i mm	S_T mm	a_x mm	B_i mm	a_T min mm
0455	25	3	20	25	12.5
0455	25	3	20	38, 58, 78	19
0455	25	3	20	103	21.5
0455	25	3	20	130	25
0555	36	3	25	50 ... 150	25
0665	42	5	25	50 ... 175	25

The dividers are fixed at an interval of a_x .

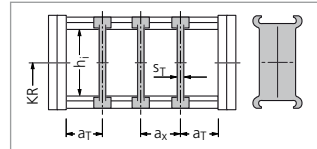

In the standard version, the divider systems are mounted on every second chain link.

For type 0665, the divider system TS 1 with a central height subdivision ($S_H = 4$ mm) is also available.

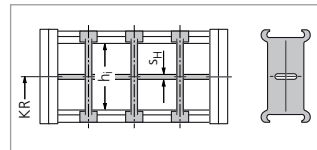

Font:
+49 2762 4003-0

OnlineEngineer.de
The online engineer
Cable carrier configuration

UNIFLEX – Types 0345, 0455, 0555 and 0665

Strain relief devices for plastic connectors

Inside heights



Inside widths



ZLK – A

Connecting elements with integrated, strain relief combs on both sides (ZLK – A)

ZLK – L

Connecting elements with screw-on type strain relief combs (ZLK – L)

The strain relief combs are generally supplied with the connecting elements.

The combs are either clipped to the end connectors and bolted together with them, or screwed on at the desired intervals, behind the connecting boreholes, behind the connecting elements.

kabelschlepp.de



Connecting elements Type 0345

Connecting elements with integrated strain relief combs on both sides

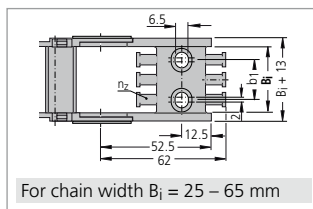
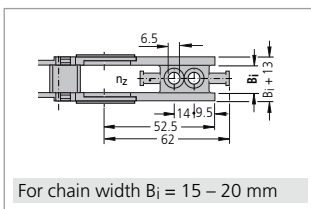
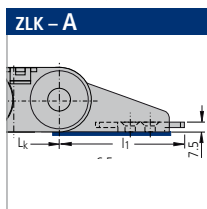

The dimensions of the fixed point and driver connections are identical.

Use our free
project planning service.

Type	B_i	B_k	b_1	n_z
034515	15	28	–	1
034520	20	33	–	1
034525*	25	38	13	2
034538	38	51	24	3
034550	50	63	36	4
034565	65	78	51	5

* Type 034525 with 6.5 mm hole (not an elongated hole)

Dimensions in mm

UNIFLEX – Types 0345, 0455, 0555 and 0665

Connecting elements Type 0455

Connecting elements with strain relief combs on both sides

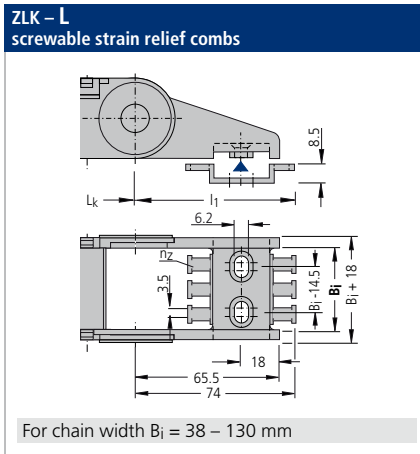
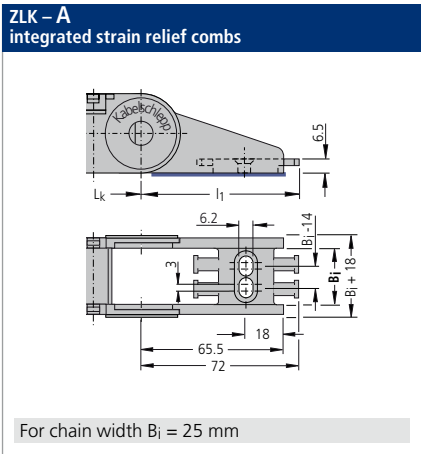

Inside heights



Inside widths



kabelschlepp.de

The dimensions of the fixed point and driver connections are identical.

Type	B_i	B_k	n_z
045525	25	43	2
045538	38	56	3
045558	58	76	4
045578	78	96	6
0455103	103	121	8
0455130	130	148	10

Dimensions in mm

Connecting elements Type 0555

Connecting elements with strain relief combs on both sides

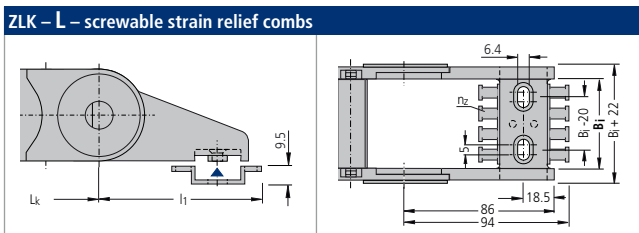

The dimensions of the fixed point and driver connections are identical.

Type	B_i	B_k	n_z
055550	50	72	4
055575	75	97	6
0555100	100	122	8
0555125	125	147	10
0555150	150	172	12

Dimensions in mm

Font:
+49 2762 4003-0

OnlineEngineer.de
The online engineer
CAD/CAM/CAE/PLM

UNIFLEX – Types 0345, 0455, 0555 and 0665

Connecting elements Type 0665

Connecting elements with strain relief combs on both sides

Inside heights



Inside widths

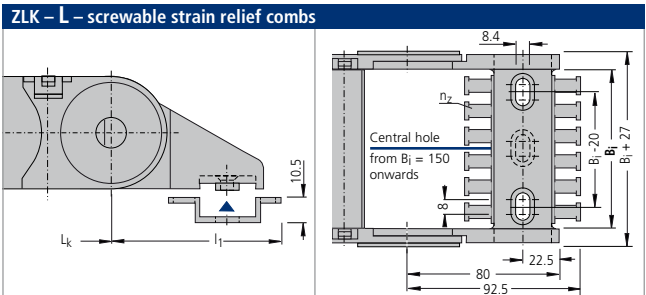

The dimensions of the fixed point and driver connections are identical.

Type	B _i	B _k	n _z
066550	50	77	4
066575	75	102	6
0665100	100	127	8
0665125	125	152	10
0665150	150	177	12
0665175	175	202	14

Dimensions in mm

kabelschlepp.de

Fon: +49 2762 4003-0

Use our free project planning service.

Connection variants for design 060

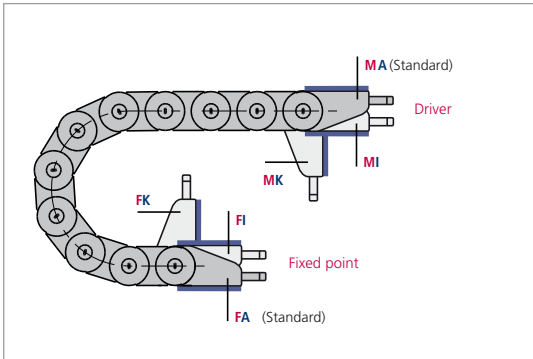

Connection point

- M** – Driver
- F** – Fixed point

Connection type

- A** – Threaded joint outside (standard)
- I** – Threaded joint inside
- H** – Threaded joint, rotated through 90° to the outside
- K** – Threaded joint, rotated through 90° to the inside

In the standard version, the connectors are mounted with the threaded joint outwards (**FA/MA**).

When ordering please specify the desired connection type (see ordering key on page 416).

The connection type can subsequently be altered simply by varying the connectors.

UNIFLEX – Types 0345, 0455, 0555 and 0665

UMB (Universal Mounting Brackets) made of aluminum



Universal connectors for connection above, below or at the front.

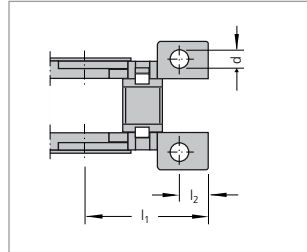
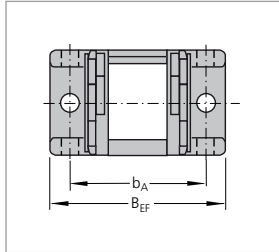
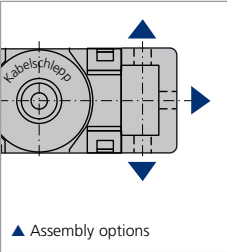

The dimensions of the fixed point and driver connections are identical.

When ordering please specify the connection type FU/MU (see ordering key on page 416).

Type	B_{EF}	b_A	l_1	l_2	d
0345	$B_i + 30$	$B_i + 20$	36	9	5.5
0455	$B_i + 30$	$B_i + 20$	47	10.5	5.5
0555	$B_i + 40$	$B_i + 28$	57	13.5	6.5
0665	$B_i + 44$	$B_i + 28$	68	14.5	8.5

Dimensions in mm

Inside heights



Inside widths



kabelschlepp.de

Font:
+49 2762 4003-0

OnlineEngineer.de
The online engineer for cable carrier configurations

Guide channels
► from page 375

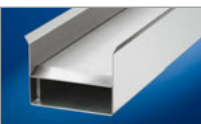

Strain relief devices
► from page 381



Cables for cable carrier systems
► from page 438



UNIFLEX – Type 0600 Tube, lightweight construction

Design 080 – cable carriers covered on both sides

Outside and inside: Covered
 Outside: Detachable cover

Innenhöhe
 44

Inside widths
 50
 125

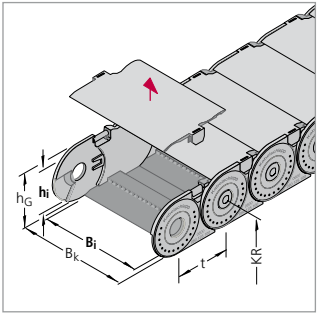

Cable carrier covered on both sides in a **lightweight design**. Can be opened on the outside for fast cable laying. Provides particularly good protection for the cables from all types of contamination, machining chips and moisture.

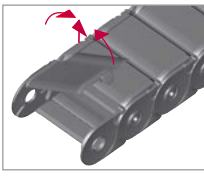

Also available with hinged cover – please contact us.

kabelschlepp.de

Dimensions and intrinsic chain weight

Type	h _i	h _G	Inside widths B _i				B _k
			50	75	100	125	
0600	44	61	1.60	1.88	2.15	2.42	B _i + 18
			Intrinsic chain weight				

Dimensions in mm/Weights in kg/m

Fon: +49 2762 4003-0

Bend radius and pitch

Bend radii KR mm				
100	125	150	175	200

Pitch t = 60.0 mm

Use our free project planning service.

Example of ordering

Cable carrier				Divider system		Connection
0600	080	125	175	1800	TS 0 / 3	FU/MU
Type	Design	Inside width B _i in mm	Bend radius KR in mm	Chain length L _k in mm (with-out connection)	Divider system	Number of dividers n _T
						Connection Fixed point/Driver

Ordering divider systems:

Please state the designation of the divider system (TS 0, TS 1 ...) and the number of dividers. Possibly attach a sketch with the dimensions.

UNIFLEX – Type 0600 Tube, lightweight construction

Load diagram

for unsupported length L_f depending on the additional load

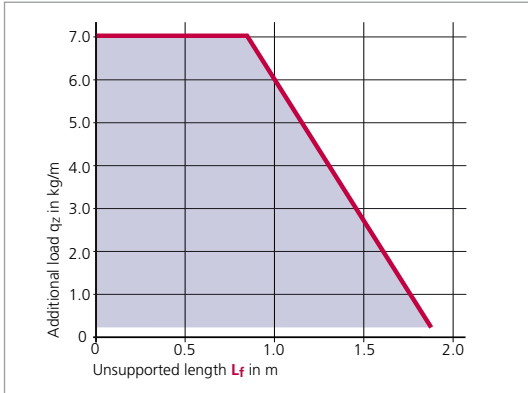

Unsupported length L_f

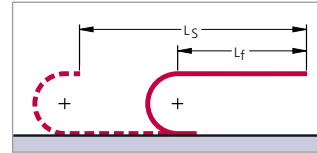

In the case of longer travel lengths, sag of the cable carriers is technically permissible depending on the application.

In a gliding arrangement, even longer travel lengths are possible (see page 375).

We are at your service to advise on these applications.

Innenhöhe



Inside widths



kabelschlepp.de

Divider system TS 0

Type	h_i mm	S_T mm
0600	44	3

In the standard version, the dividers can be moved in the cross section. The dividers can be fixed in 10 mm sections simply by re-attaching.

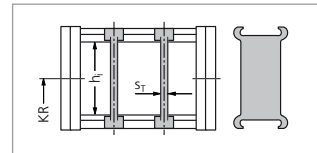

In the standard version, the divider systems are mounted on every second chain link.

Divider system TS 1 with continuous height subdivision

Type	h_i mm	S_T mm	S_H mm	h_1 mm	h_2 mm
0600	44	3	4	14	28

In the standard version, the dividers can be moved in the cross section. The dividers can be fixed in 10 mm sections simply by re-attaching.

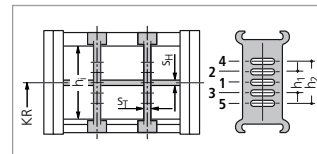

In the standard version, the divider systems are mounted on every second chain link.

Fon: +49 2762 4003-0

UMB (Universal Mounting Brackets) made of aluminum

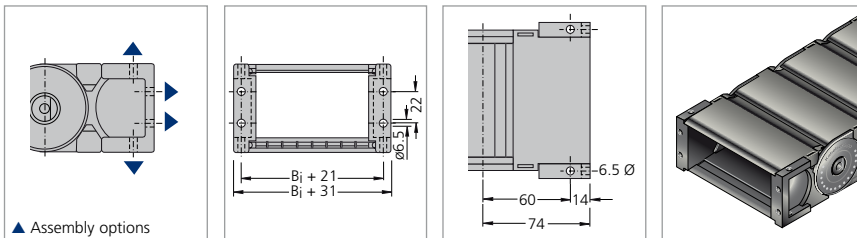

The dimensions of the fixed point and driver connections are identical.

When ordering please specify the connection type FU/MU (see ordering key on page 416).

OnlineEngineer.de
The online engineer for cable carrier configuration